

FOR SLUDGE FORCEMAIN  
SEE DWG. No. MS-21C

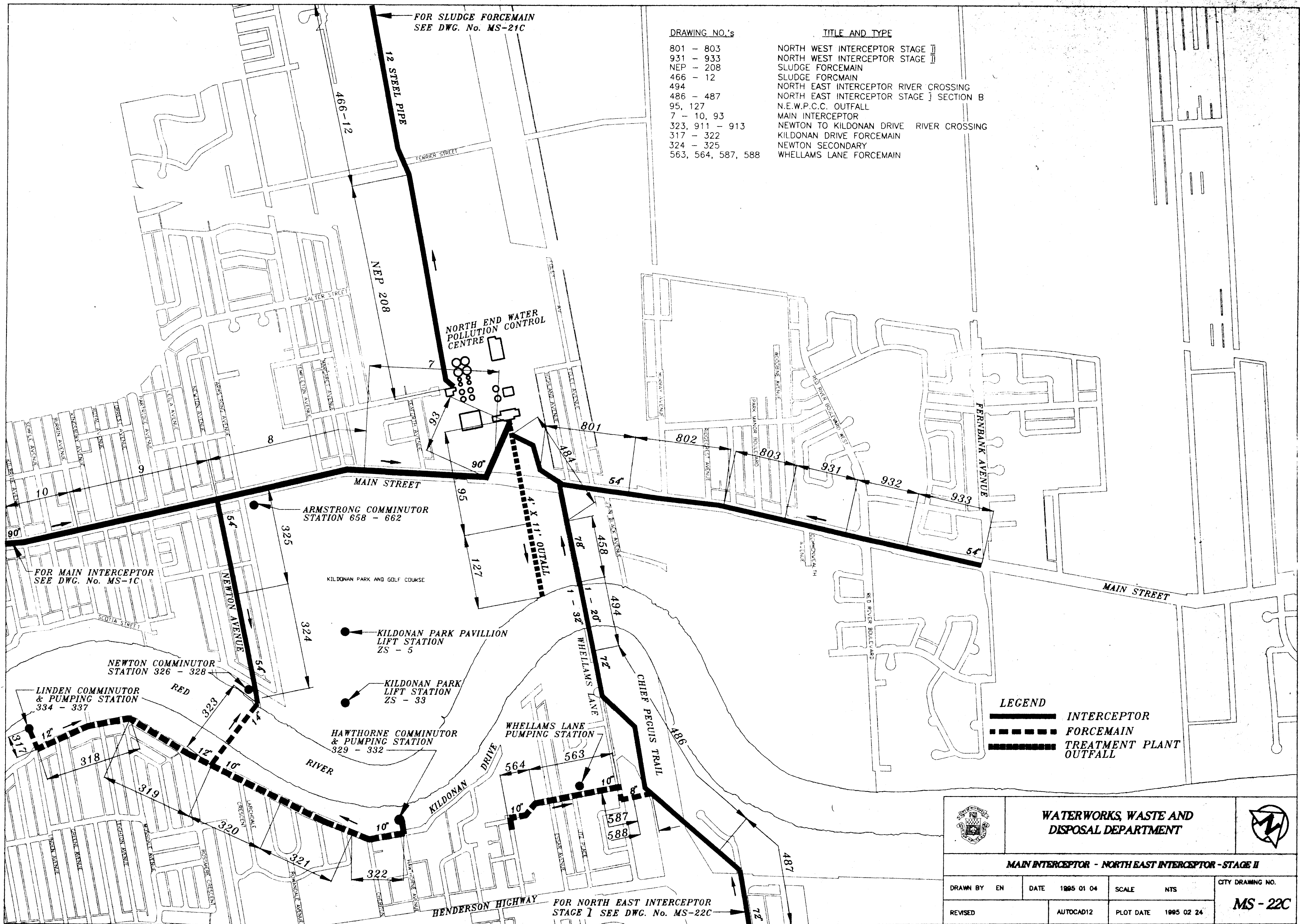

DRAWING NO.'s

TITLE AND TYPE

801 - 803	NORTH WEST INTERCEPTOR STAGE II
931 - 933	NORTH WEST INTERCEPTOR STAGE II
NEP - 208	SLUDGE FORCEMAIN
466 - 12	SLUDGE FORCEMAIN
494	NORTH EAST INTERCEPTOR RIVER CROSSING
486 - 487	NORTH EAST INTERCEPTOR STAGE I SECTION B
95, 127	N.E.W.P.C.C. OUTFALL
7 - 10, 93	MAIN INTERCEPTOR
323, 911 - 913	NEWTON TO KILDONAN DRIVE RIVER CROSSING
317 - 322	KILDONAN DRIVE FORCEMAIN
324 - 325	NEWTON SECONDARY
563, 564, 587, 588	WHELLAMS LANE FORCEMAIN



**LEGEND**  
 ——— INTERCEPTOR  
 - - - - - FORCEMAIN  
 ······ TREATMENT PLANT OUTFALL

 <b>WATERWORKS, WASTE AND DISPOSAL DEPARTMENT</b> 			
<b>MAIN INTERCEPTOR - NORTH EAST INTERCEPTOR - STAGE II</b>			
DRAWN BY	EN	DATE	1995 01 04
SCALE	NTS		CITY DRAWING NO.
REVISED	AUTOCAD12	PLOT DATE	1995 02 24
			<b>MS - 22C</b>